

(1)	(2)	(3)	(4)	(5)	(6)	(7)	(8)	(9)	(10)
SMR	Federal	DESCRIPTION	UNIT	Qty	30-day DS maint	30-day GS maint	1-yr Depot	Illustration	
Code	Stock		of	inc.	allowance	allowance	alw	maint	
	Number		meas	in			per	alw	
				Unit			100	per	(a)
							equip	100	Figure
							cnt-	equip	No.
					(a)	(b)	(c)	(a)	(b)
					1-20	21-50	51-100	1-20	21-50
								gcy	

Reference Number & Mfr. Code

Usable On Code

1004-STEERING AND LEANING WHEEL
MECHANISM-CONTINUED

P-F	2520-692-616	SPACER, UNIVERSAL JOINT: 8332702 (19207)	A	EA	2	*	*	*	*	*	*	6	20	72	11
P-F	2520-734-698	SPACER, SLEEVE: UNIVERSAL JOINT 7346987 (19207)	A	EA	2	*	*	*	*	*	*	6	20	72	11
P-F	5305-734-698	SET SCREW: SLEEVE SPACER 7346988 (19207)	A	EA	2	*	*	*	*	*	*	6	10	72	12
X1		SHAFT: 8758348 (19207)	A		1									72	13
P-F	5310-033-600	WASHER, FLAT: UNIVERSAL JOINT SPACER OUTER 7346986 (19207)	A	EA	2	*	*	*	*	*	*	6	10	72	14
P-F	5330-286-705	SEAL, PLAIN, ENCASED: SHAFT 500135 (21450)	A	EA	2	*	*	*	*	*	*	20	200	72	15
P-F	2520-734-695	SEAL ASSEMBLY: 7346951 (19207)	A	EA	2	*	*	*	*	*	*	10	40	72	16
P-F	2520-734-698	SPACER SET: TRUNNION SOCKET BEARING PIN MPS513 (02413) CONSISTING OF:	A	EA	1	*	*	*	*	*	*	10	40		
	2530-312-080	2-SPACER 0.125 1244B548 (78500)													
		2-SPACER 0.135 1244C549 (78500)												71	32
	2530-312-081	2-SPACER 0.145 1244D550 (78500)													
		2-SPACER 0.155 1244E551 (78500)													
	2530-312-081	2-SPACER 0.165 1244F552 (78500)													

GROUP 11-REAR AXLE

		1100-REAR AXLE ASSEMBLY													
P-F-R	2520-200-128	AXLE ASSEMBLY, AUTOMOTIVE : ALL MODELS EXCEPT IA, HA, JA, BD, IK, FJ, BG, LA, MA, ZA, BO, HB 8327007 (19207)	BE	EA	2	*	*	*	*	*	*	6	10	73	1
P-F-R	2520-200-128	AXLE ASSEMBLY, AUTOMOTIVE: 8327216 (19207)	HA, JA, BG, BD, IK, FJ	EA	2	*	*	*	*	*	*	6	10	73	1
P-F-R	2530-734-699	AXLE ASSEMBLY: AUTOMOTIVE 7346997	EA, CB	EA	2	*	*	*	*	*	*	6	10	73	1
P-F-R	2520-741-114	AXLE ASSEMBLY, AUTOMOTIVE: 7411141 (19207)	BE, IA, HB, LA, MA, BO	EA	2	*	*	*	*	*	*	6	10	73	1
P-F	2510-734-695	PLATE: MOUNTING BRACKET 7346952 (19207)	A	EA	2	*	*	*	*	*	*	2	5	73	2
P-F	2510-734-699	BRACKET ASSEMBLY: AXLE HOUSING 7979363 (19207)	A	EA	2	*	*	*	*	*	*	3	5	73	3
P-F		BOLT, MACHINE: MOUNTING BRACKET 7346956 (19207)	A	EA	8	*	*	*	*	*	*	6	10	73	4

Current part is item (14) on diagram. Available at www.oshkoshequipment.com

TM 9-2320-211-24P

3-76

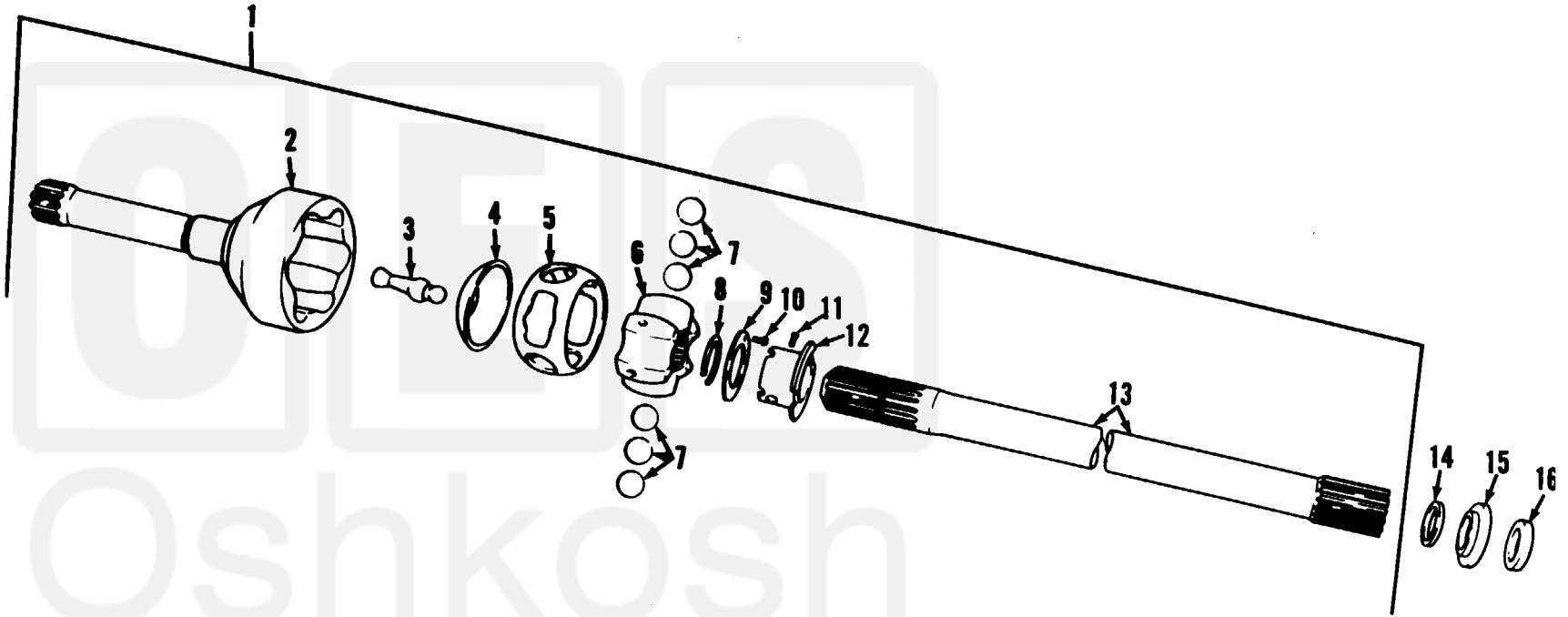

Oshkosh
Equipment Sales

AT 47211

Figure 72. Front axle shaft with universal joint assembly.

Current part is item (14) on diagram. Available at www.oshkoshequipment.com